

Comant CI 157P

VOR/LOC/GS

COBHAM

The most important thing we build is trust

CI 157P VOR/LOC/GS

"V" Dipole VOR/LOC/GS antenna with fixed elements designed specifically for compatibility with the Piper Aircraft mounting. Integral ferrite balun provides for higher radiation efficiency replacing cumbersome coaxial baluns previously utilized. Radiating elements are not removable.

Applications

Consult your FBO or installation shop for best application information.

Not approved for helicopter installations.

Frequencies Covered

108-118 MHz (VOR/LOC), 329-335 MHz (GS)

Specifications

Electrical

Frequency	108-118 MHz (VOR/LOC) 329-335 MHz (GS)
VSWR	3.0:1 Max. 108-118 MHz (VOR/LOC) 3.0:1 Max. 329-335 MHz (GS)
Polarization	Horizontal
Radiation Pattern	Dipole
Impedance RF	50 Ohms Nominal
Power RF	Receive Only

Mechanical

Weight	0.5 lbs. Maximum
Height	18.6 inches Maximum
Finish	Black housing / Stainless steel whips
Connector	BNC

Environmental

Temperature	-55 C to +85 C
Altitude	50,000 ft

Federal Specifications

FAA TSO	C34e, C36e, C40c
RTCA MOPS	DO-192, DO-195, DO-196
RTCA Environmental	DO-160C



WARNING: Use factory supplied drawings and specifications for installation. Refer to FAA AC 43.13-2B for installation guidelines.

Order at:

Tel: 714-870-2420 Fax: 714-870-6294
Email: comantorders@cobham.com

REV	DESCRIPTION	DATE	APPROVAL
A	ADDED GROOVE LUG	05/07/18	DDM
B	REVISIONS 5-10-18 AND 1-13-18. ADDIT. Δ DWG NOTE 4	01/11/19	DS 02/19
C	REF ECH 54-495	01/09/19	DI 02/19
D	REF ECH 54-425	10/18/19	DI 10/18/19

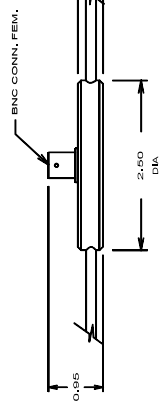
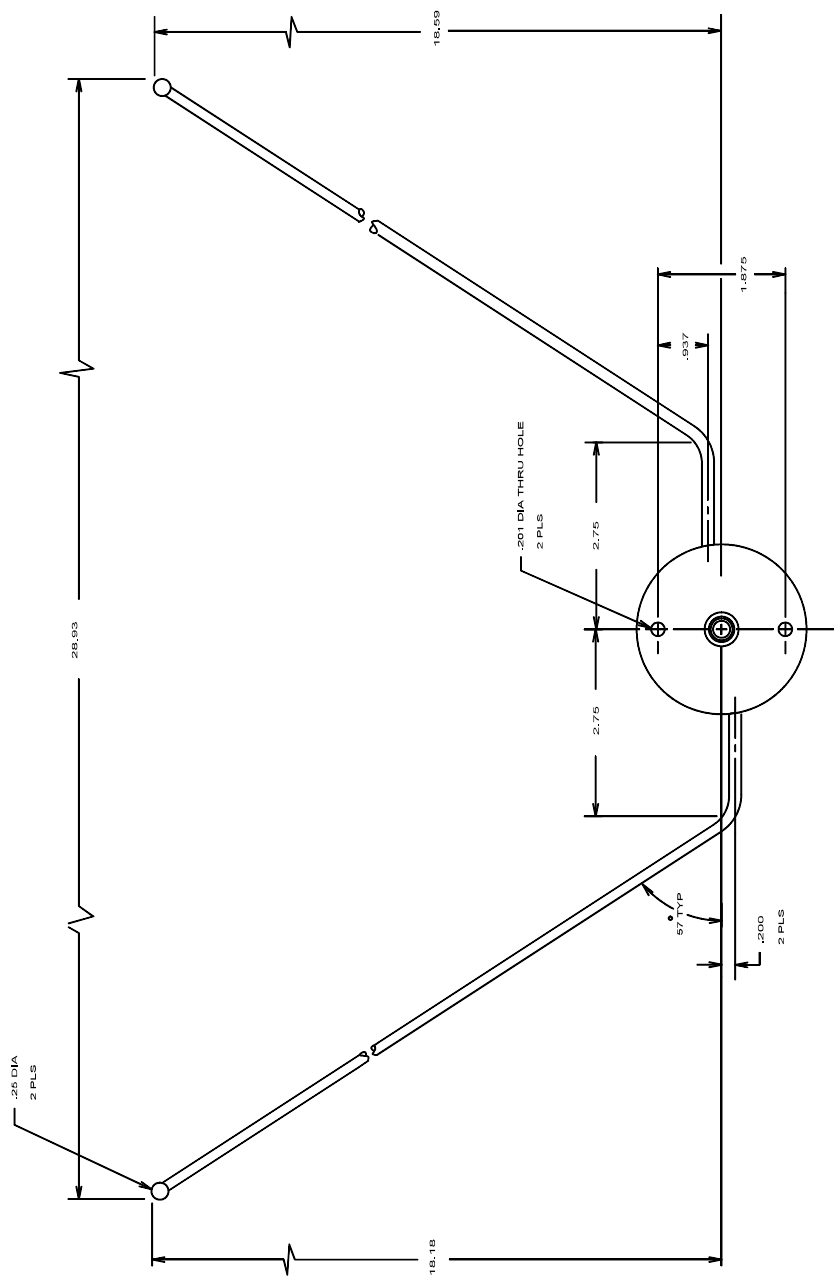

- NOTES:
- RF CHARACTERISTICS:
 - FREQUENCY: 100-110 MHz and 329-335 MHz
 - VSWR: 3.0:1 MAX.
 - POLARIZATION: HORIZONTAL
 - IMPEDANCE: 50 OHMS
 - ANTENNA BALUN IS INTEGRAL TO MOUNTING BASE.
 - WEIGHT: 0.5 LB.
 - AIRSPED RATING: 250 KNOTS TAS
 - T50 0344, C394, C400, DO-1000 ENV. CAT: (A2F3W4C1E1M)XXXXXXXXXXXXXXXXXXXX

ANTENNA - DIPOLE VOR/LOC/GLIDE SLOPE	
CONTRACT NO. DATE: 01/14/18	DRAWN: DS 02/19 CHECK: DS 02/19 ENGR: DS 02/19 APPD: DS 02/19
DIMENSIONS UNLESS NOTED OTHERWISE DIM. IN INCHES UNLESS NOTED OTHERWISE MATERIALS TO BE USED AS SHOWN UNLESS NOTED OTHERWISE FINISHES TO BE USED AS SHOWN UNLESS NOTED OTHERWISE MATERIALS TO BE USED AS SHOWN UNLESS NOTED OTHERWISE	TITLE: ANTENNA - DIPOLE VOR/LOC/GLIDE SLOPE CURE IDENT: 51351 DWG. NO.: C1157P SCALE: 1:1 SHEET: 1 OF 1